

Bring your Art to your Frame TV

This guide will help you to transfer the Frame TV Art from the deBlurr Google Drive to a Samsung Frame TV. It is focused on the use of the Samsung "Smart Things" App.

Requirements

- Samsung The Frame TV
- Smartphone
- Samsung SmartThings App installed on your smartphone. Available in your app store

Go to the Google Drive and Download a Picture

- 1 Download and opened the Access PDF from Etsy on your smart phone.
- 2 Click on the first link below „Access to Google Drive“.

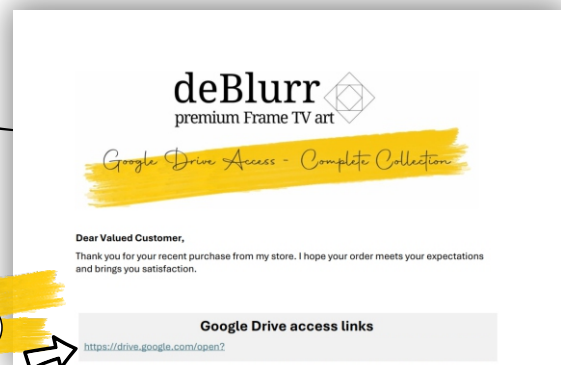

- 3 After you clicked on the link you will receive the question if you are willing to go to the Google Drive. Click "open"
- 4 (Optional) Choose an email with which you would like to access to the Google Drive. Click „OK“.

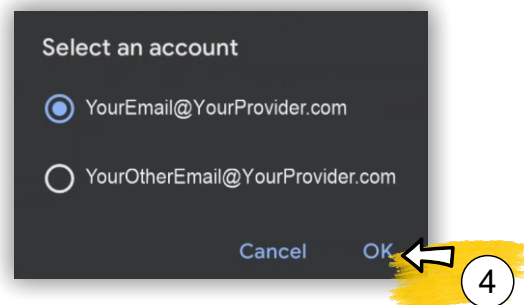
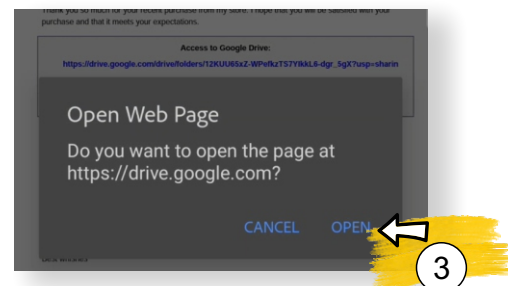

- 5 You are brought to the Google Drive where the artworks are saved. Click through the folder and select an image you like and click on the three dots.

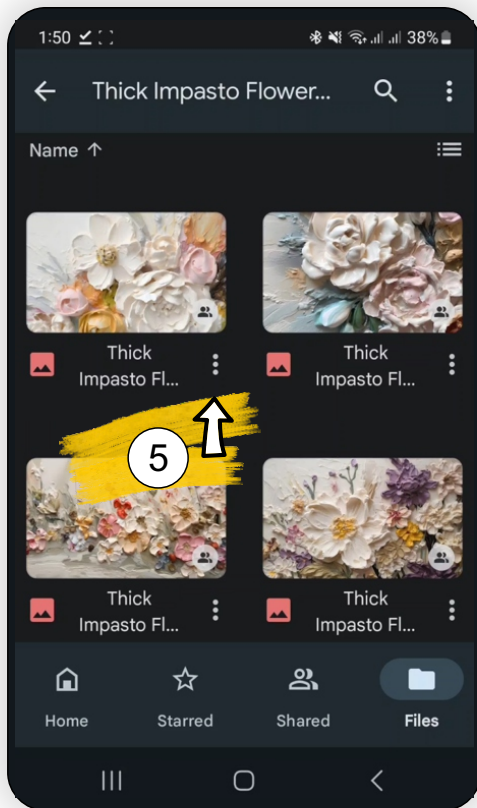

- 6 Click the download button

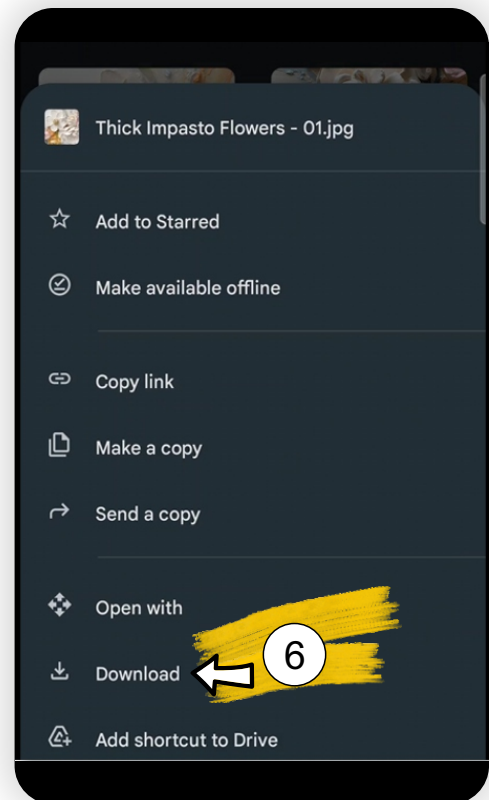

- 7 You will receive a push message when your download is complete

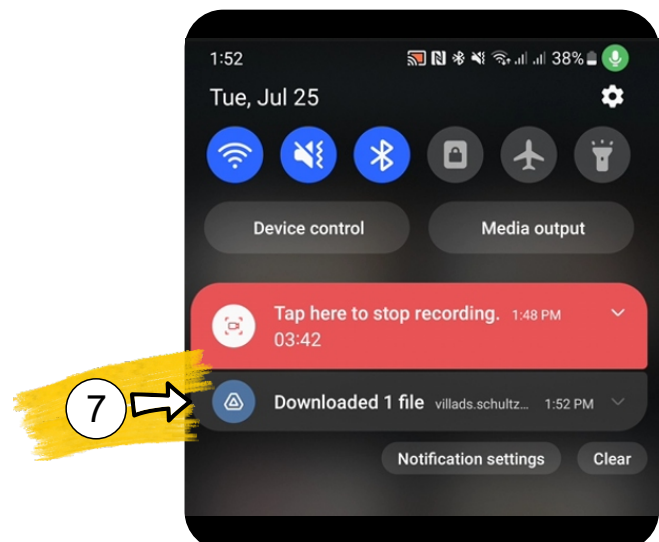

- 8 Open your "Smart Things" app (be sure it is installed on your smart phone!)



- 9 Connect your smart phone with your Frame TV.

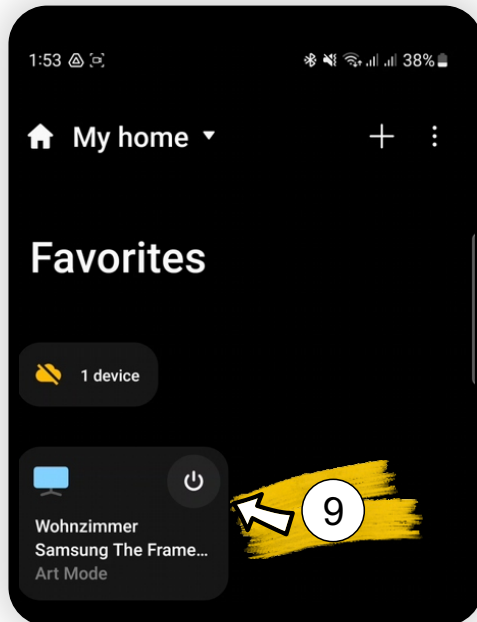

- 10 Click on Art Mode

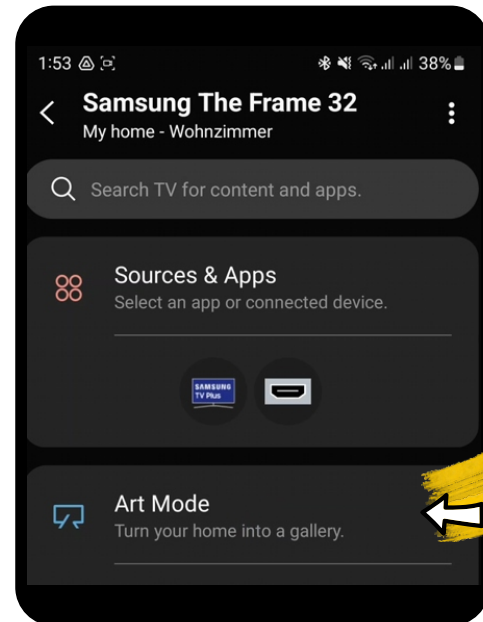

- 11 "Art Mode" will open.

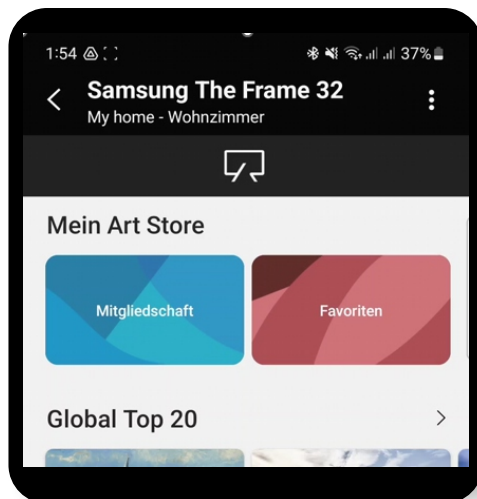

- 12 Scroll down to "My Photos". Click on it!

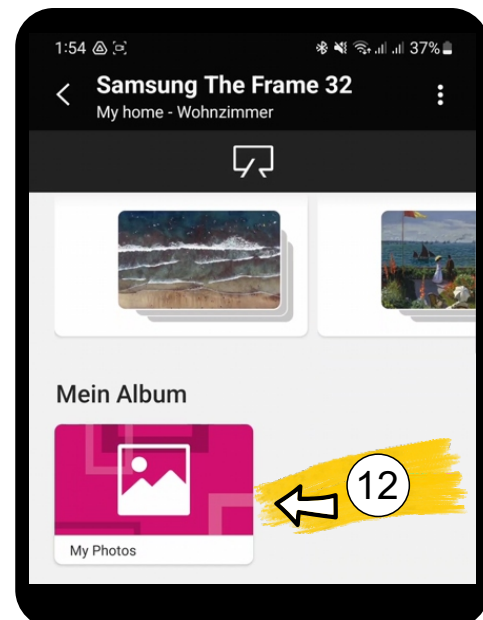

13 Already existing pictures are shown

14 Click the blue button to add further pictures

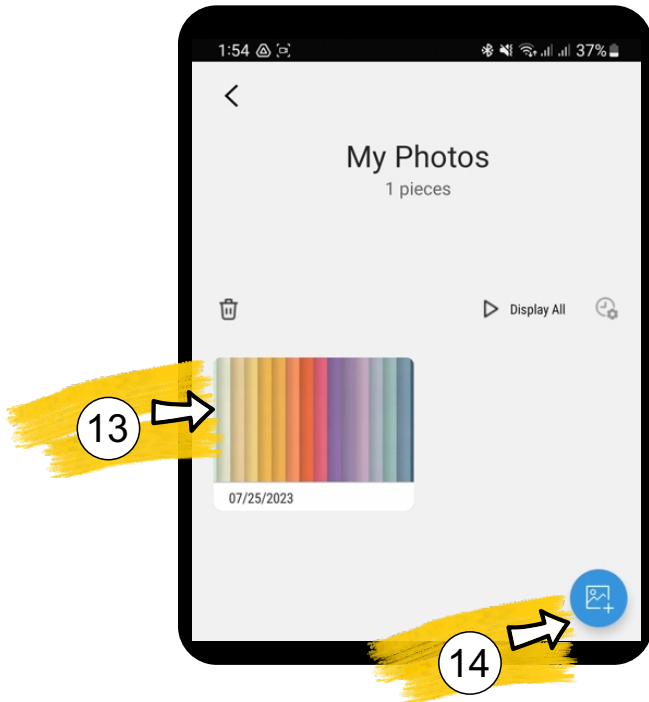

15 Click the dropdown

16 Brows to the folder where your downloaded artwork is saved (usually it is the download folder)

17 Now your downloaded artwork is shown below, and you can choose it

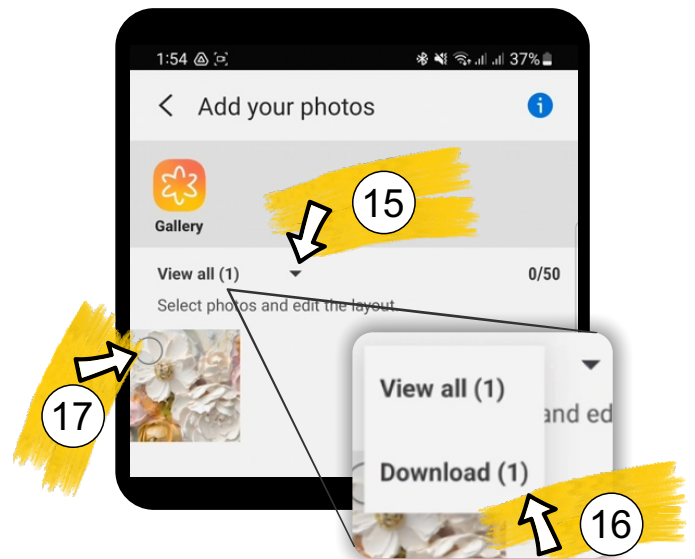

18 Choose the mat settings and send it to your TV by "Set on The Frame".

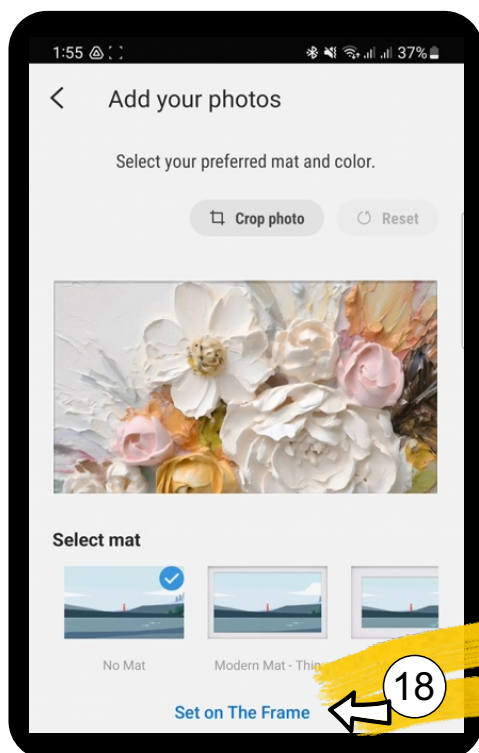

19 Sending! After this is done check you're The Frame TV

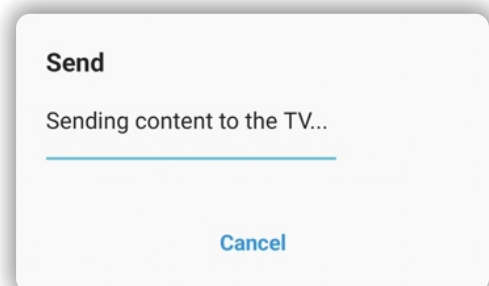

I hope this guide helped you with your settings. If you have any further questions, please get in touch on Etsy.